

Undercounter Warewasher

Quick User Guide



Caution

Only use this Quick User Guide after the Dishwasher has been fully commissioned.

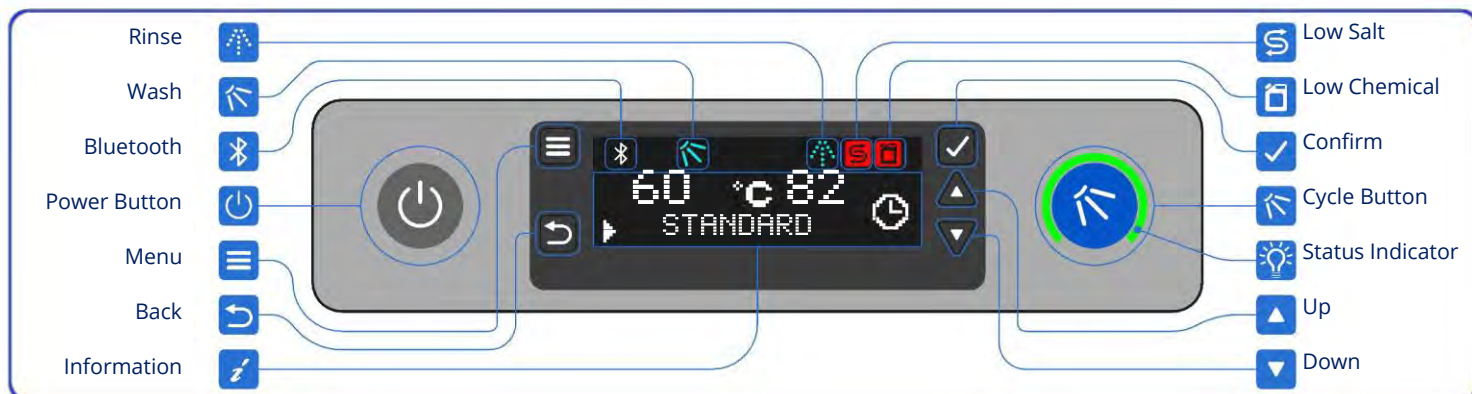

1

Turning the Washer on

Press the Power Button. The Status Indicator will turn Amber, which indicates the machine is filling and heating. You may load the dishwasher whilst this is happening.



2

Loading the Dishwasher

Open the door and load the basket. Rinse off any debris from the items and then place them into the basket. Once complete, close the door.

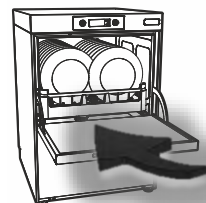

3

Dishwasher Start Cycle

Once the machine is ready. The Status indicator will change from Amber to Green. Your machine is now ready to be used.

4

Confirming your Selection

Once your machine is ready, press the Cycle button. The indicator will illuminate Blue and your machine is now in wash.



FILLING



READY



WASHING

Shutdown Options



We recommend you drain the machine at the end of every service.

- Press the "Power Button"
- Press the "Up/ Down" button to find your desired option
- Press "Confirm" once selected

Wash Cycle Time (Optional)



Press the "Up/ Down" button to select your intended wash cycle time. Press "Confirm" once selected.

Program Time (minutes)		
	Dish	Glass
Intensive	5	
Standard	3	2
Light	2	1.5



CLASSEQ

Visit
our
app
here!



Undercounter Warewasher

Quick User Guide



Low Salt Warning (WS Only)

Low salt – The following icon will present itself if your machine is low on salt.



Replenish the salt as soon as possible to prevent limescale from building up within your machine.

To refill the salt reservoir, follow these steps below:

- Unscrew cap
- Fill with Fresh water
- Fill up the salt reservoir using a funnel
- Fasten the cap back on

Wipe away excess salt. Drain down machine to remove salt water



DO NOT OVERTIGHTEN THE CAP

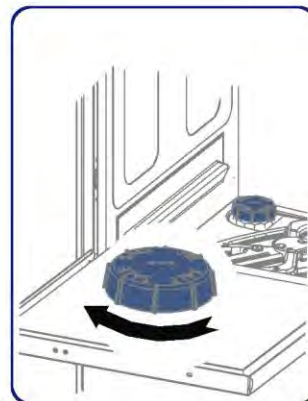
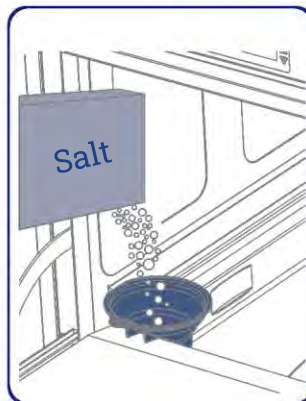
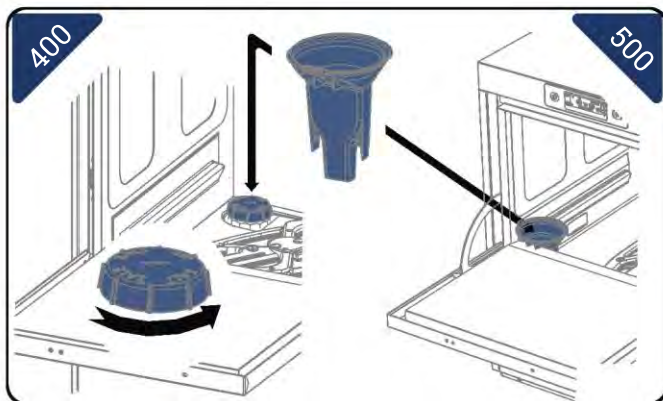

Daily Cleaning

The interior of the machine should be cleaned after each service when the machine is drained down.

- Remove and clean top + bottom wash arms (1).
- Use a trigger spray bottle with a jet nozzle to spray the anti-siphon device (2).
- Remove and clean primary + secondary filters (3).
- Clean interior of the tank and brush away any debris around inlet/ outlets. (4)

Ensure all parts are refitted securely before turning the machine back on.

